

# SECTION 6

## Locks MNB

6

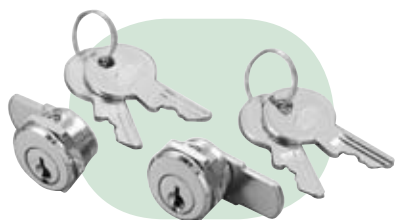



6-5

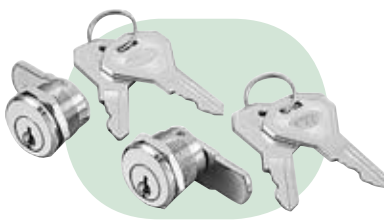

6-6



6-7

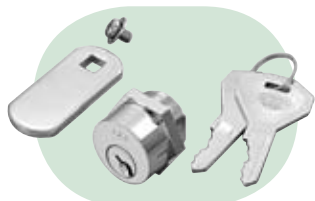

6-8

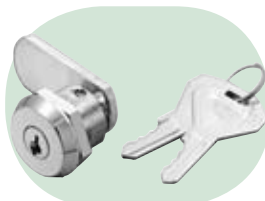

6-9



6-10

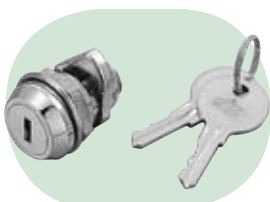

6-11

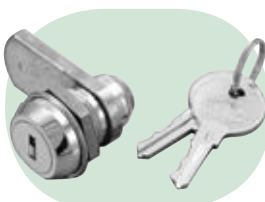

6-12

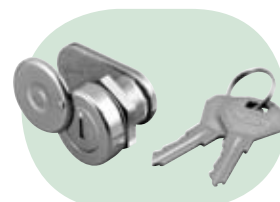

6-13

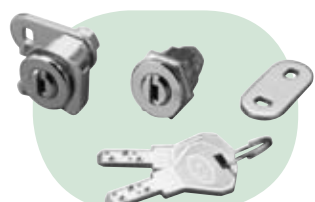

6-14



6-15

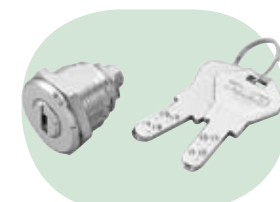

6-16 & 6-17

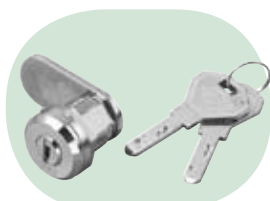

6-18

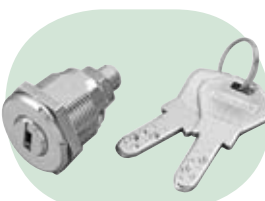

6-19



6-20

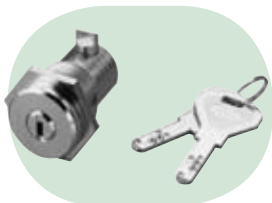

6-21

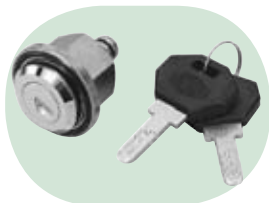

6-22

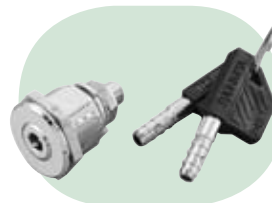

6-23

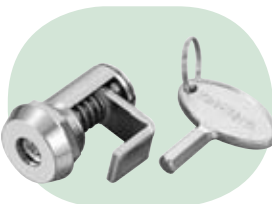

6-24

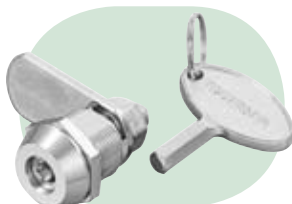

6-25

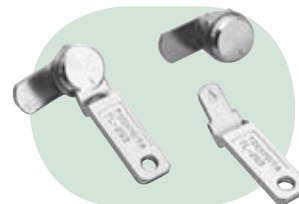

6-26

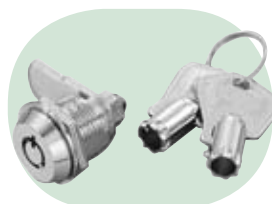

6-27

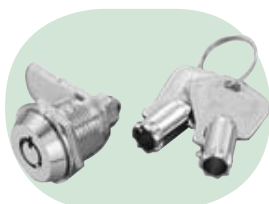

6-28

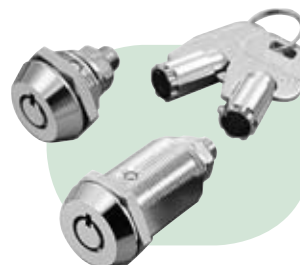

6-29

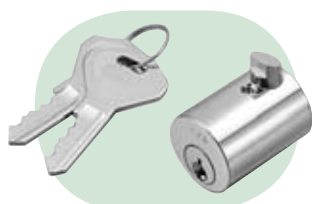

6-30

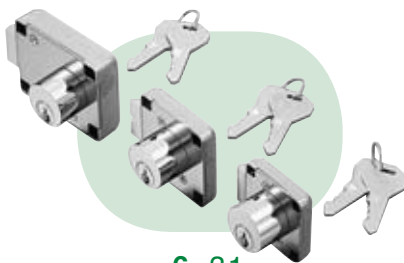

6-31



6-32

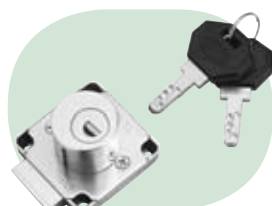

6-33

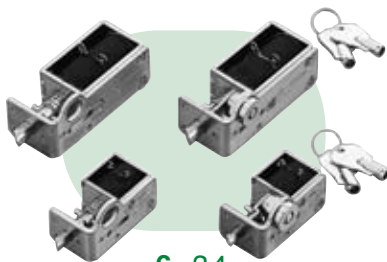

6-34

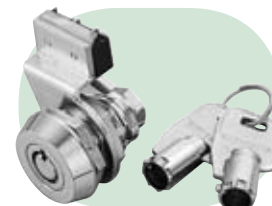

6-35

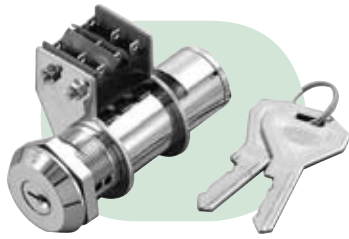

6-36

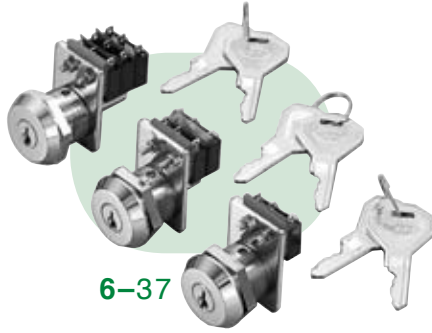

6-37

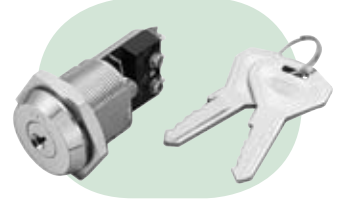

6-38

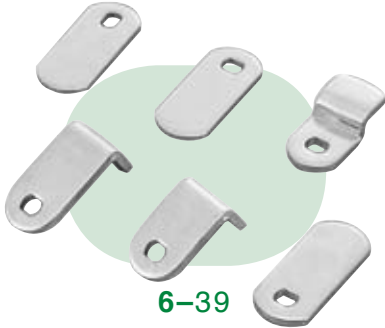

6-39



• **APPLICATIONS**

Small cabinets / Various types of small devices

• **CHARACTERISTIC**

A simple, low-cost lock.

• **SPECIFICATIONS**

1. The rotational angle of the key is 90° between points **A** and **B**.
2. The key can be inserted and removed only at point **A**.

• **PARTS LIST**

No.	Part Name	Material	Finish	Qty.
1	Lock Body	Brass	Chrome Plated	1
2	Nut		Nickel Plated	
3	Set Screws			2
4	Keys			
5	Lever	Steel	Zinc Plated	1

• **LOCKS**

Catalog Number	Specifications	Key No.	Net Weight g
MNBT10MTL110-1	Left-Side Lock	110	41.5
MNBT10MTL110-2	Right-Side Lock		

6

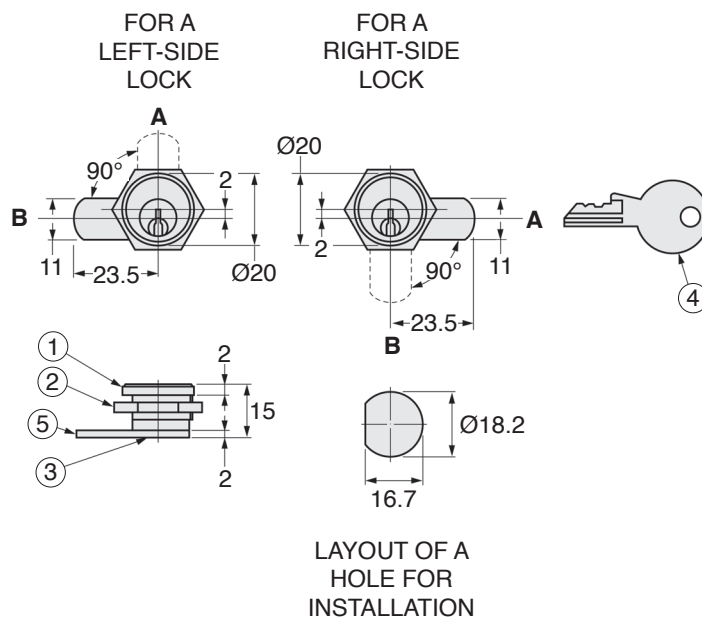

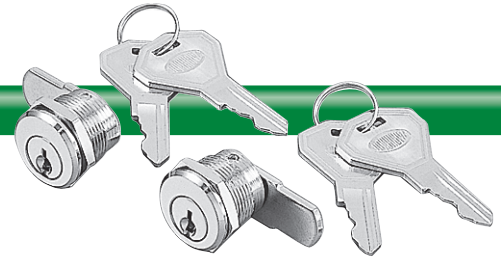

• **APPLICATIONS**

Small cabinets / Various types of small devices

• **CHARACTERISTIC**

A simple, low-cost lock.

• **SPECIFICATIONS**

1. The rotational angle of the key is 90° between points **A** and **B**.
2. The key can be inserted or removed only at point **A**.
3. The key number is identical for both locks in stock.

• **PARTS LIST**

No.	Part Name	Material	Finish	Qty.
1	Lock Body	Brass	Chrome Plated	1
2	Nut		Nickel Plated	
3	Set Screws			2
4	Keys			
5	Lever	Steel	Bright Zinc Plated	1

• **LOCKS**

Catalog Number	Specifications	Key No.	Net Weight g
<b>MNBT11MTL121-1</b>	Left-Side Lock	121	51.9
<b>MNBT11MTL121-2</b>	Right-Side Lock		

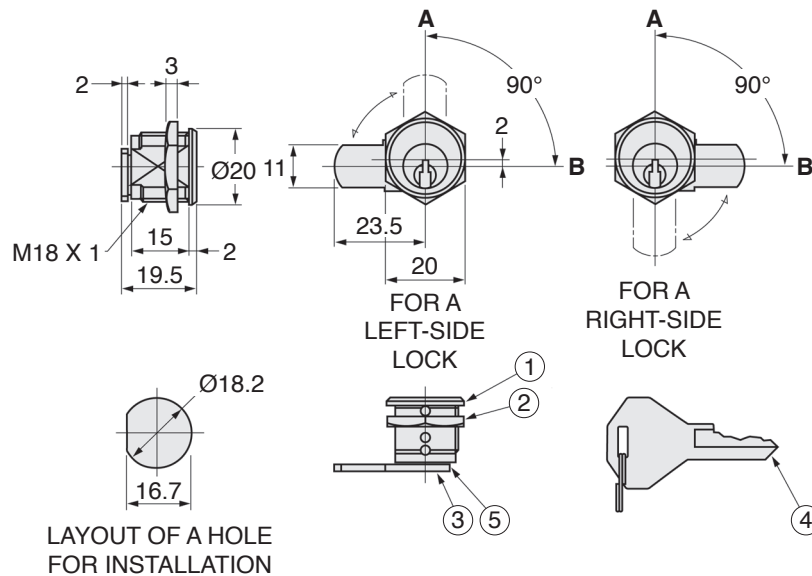

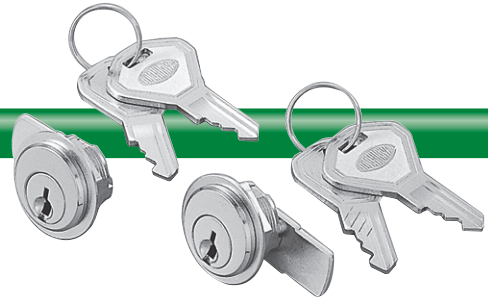

• **APPLICATIONS**

Small cabinets / Various types of small devices

• **CHARACTERISTIC**

This lock is thin, simple and economical.

• **SPECIFICATIONS**

1. The rotational angle of the key is 120° between points **A** and **B**.
2. The key can be inserted or removed only at point **A**.
3. The key number is identical for both locks in stock.

• **PARTS LIST**

No.	Part Name	Material	Finish	Qty.
1	Lock Body	Zinc Die Cast	Chrome Plated	1
2	Pan Head Screws	Steel	Zinc Plated	2
3	Lever		*	1
4	Flat Washer		Bright Zinc Plated	
5	Nut	Brass	Nickel Plated	2
6	Keys			

\*...MTL210-1 is Zinc Plated

...MTL210-2 is Bright Zinc Plated

• **LOCKS**

Catalog Number	Specifications	Key No.	Net Weight g
<b>MNBT12MTL210-1</b>	Left-Side Lock	T210	39.5
<b>MNBT12MTL210-2</b>	Right-Side Lock		

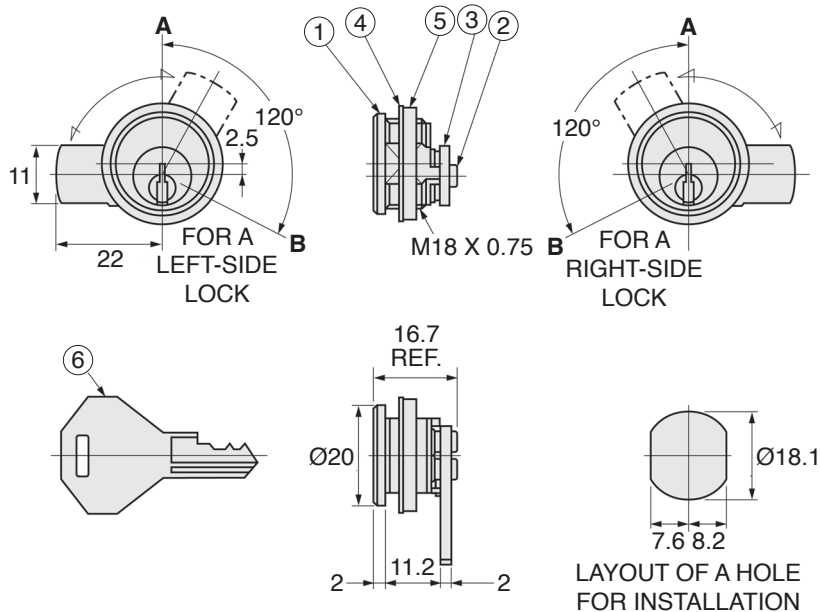

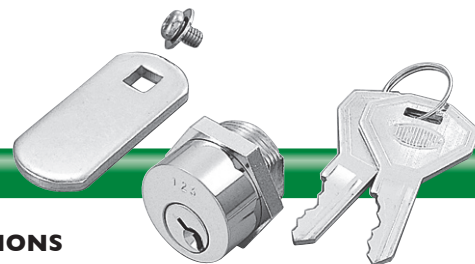

## • PARTS LIST

No.	Part Name	Material	Finish	Qty.
1	Lock Body	Brass	Chrome Plated	1
2	Hexagonal Nut		Nickel Plated	
3	Keys	Steel	Zinc Plated	2
4	Set Screw		Bright Zinc Plated	
5	*Lever			1

\*Lever sold separately.

## • LOCKS

Catalog Number	Component	Key No.	Net Weight g
<b>MNBT14MTL123-001</b>	Switch Lock with Lever, Type A	123	107.5
<b>MNBT14MTL123-002</b>	Switch Lock with Lever, Type B	2633	

## • APPLICATIONS

Theft prevention devices / Boxes

## • CHARACTERISTIC

Since the surface of the lock is flat, it can be installed flush with the surface of the panel.

## • SPECIFICATIONS

1. The rotational angle of the key is 90° between points **A** and **B**.
2. The key can be inserted and removed at points **A** and **B** for ... **MTL123-001**, and only at point **A** for ... **MTL123-002**.
3. The orientation of the locks (clockwise or counterclockwise) can be changed by setting the lever at different positions.

6

...MTL123-001

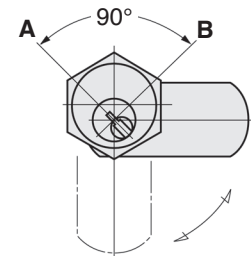

FOR A RIGHT-SIDE LOCK

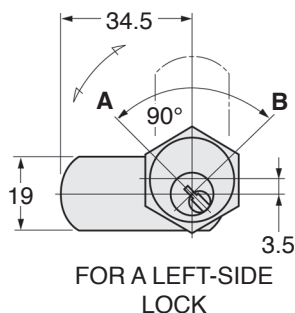

FOR A LEFT-SIDE LOCK

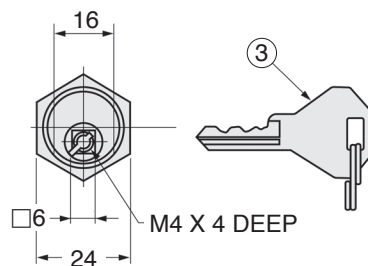
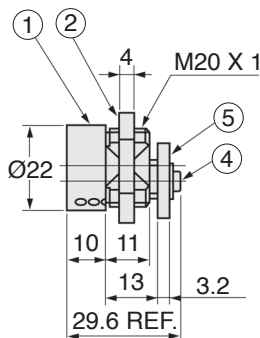

...MTL123-002

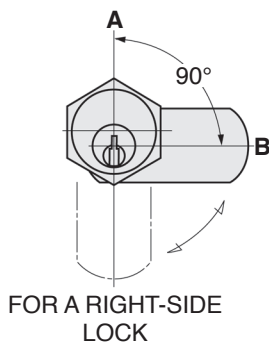

FOR A RIGHT-SIDE LOCK

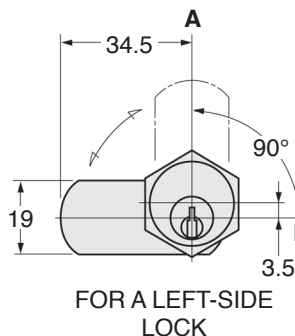

FOR A LEFT-SIDE LOCK

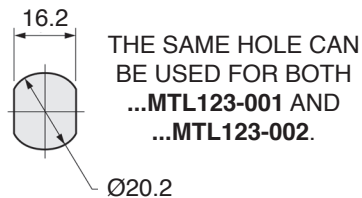
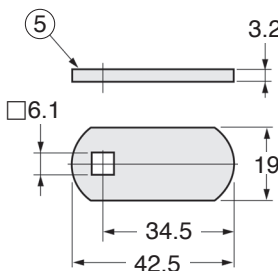
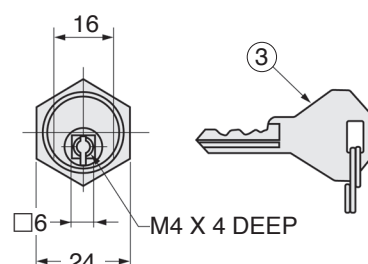
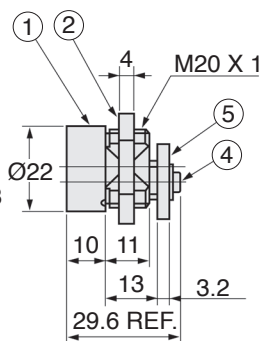

LAYOUT OF A HOLE FOR INSTALLATION



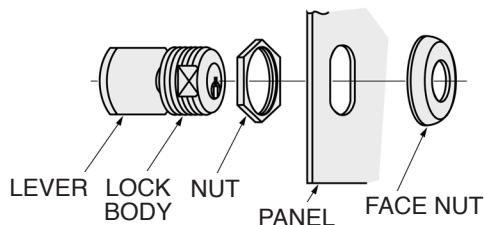
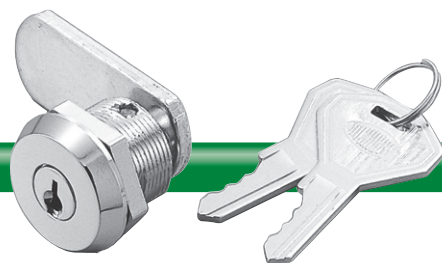

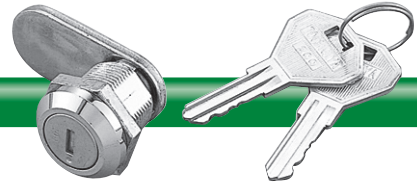

#### • APPLICATIONS

Distribution boards / Distribution panels / Locks for lids and doors in electrical facilities

#### • CHARACTERISTICS

For convenience, this lock uses the same key (No. 200) as the ones used for cabinet handle latches. The shutter on the keyhole reduces the chance of foreign material getting into the lock.

#### • SPECIFICATIONS

1. The rotational angle of the key is 90° between points **A** and **B**.
2. The key can be inserted or removed at points **A** and **B**.

#### • PARTS LIST

No.	Part Name	Material	Finish	Qty.
1	Lock	Stainless Steel / Zinc Die Cast	— / Zinc Plated	1
2	Case	Zinc Die Cast	Chrome Plated	
3	Attaching Nut		Steel	
4	Rotation Control Cam			
5	Pan Head with Cross Hole Small Screw with Washer			
6	Lever	Brass	Nickel Plated	2
7	Keys			

LAYOUT OF A HOLE FOR  
INSTALLATION (AT PANEL SURFACE)

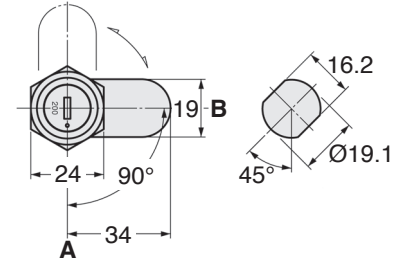

FOR A RIGHT-SIDE LOCK  
(WITHOUT REORIENTING THE CAM)

#### • LOCK

Catalog Number	Key No.	Net Weight g
<b>MNBT16MTL305</b>	200	74

**NOTE:** Care should be taken not to drop the rotation control cam while changing the lever or the orientation.

LAYOUT OF A HOLE FOR  
INSTALLATION (AT PANEL SURFACE)

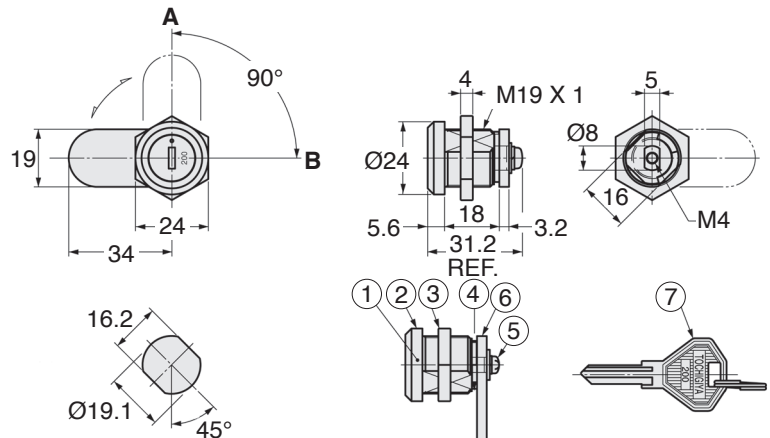

FOR A LEFT-SIDE LOCK

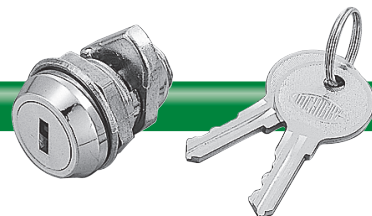

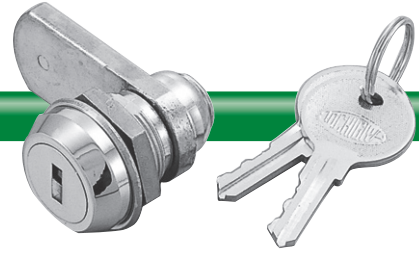

## • APPLICATIONS

Small cabinets / Various types of small devices

## • CHARACTERISTIC

The lock is extra strong due to the thick lever.

## • SPECIFICATIONS

1. The rotational angle of the key is 90° between points **A** and **B**.
2. The key can be inserted or removed at points **A** and **B**.
3. The lever can be installed with either a clockwise or counterclockwise rotation.

## • PARTS LIST

No.	Part Name	Material	Finish	Qty.
1	Keys	Brass	Nickel Plated	2
2	Tumblers		—	5
3	Inner Tube	Zinc Die Cast	Chrome Plated	1
4	Outer Tube			
5	Hexagonal Nut		Zinc Plated	
6	Lever			
7	Bowl-Shaped Washer	Steel		
8	Flat Head Screw			
9	Countersunk Washer	Phospher Bronze	—	5
10	Springs			

## • LOCK

Catalog Number	Key No.	Net Weight g
MNBT09MTL167	500	76.2

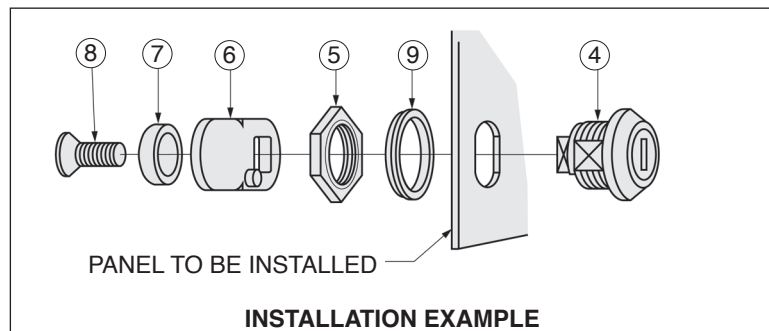
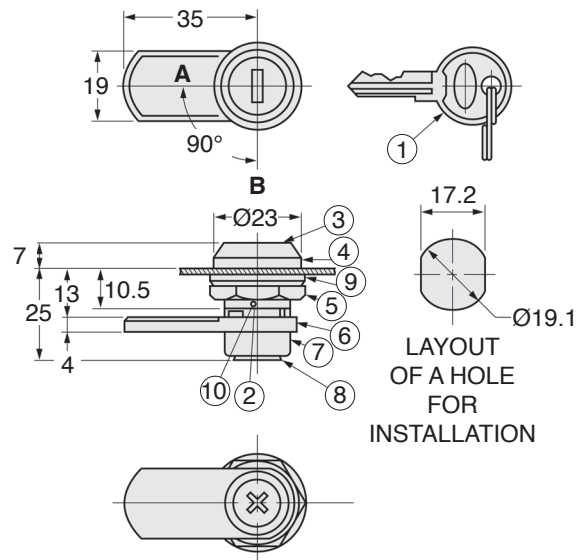



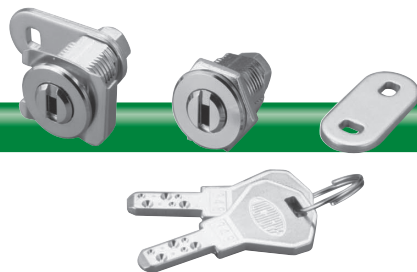

## • APPLICATIONS

Communication devices / Control boards / Office equipment

## • CHARACTERISTICS

Developed for miniaturized equipment. Smaller diameter and length than ...MTL247, but with the same security level and reversible keys. Two styles are available: one with a retainer for a quick assembly and the other with the traditional hex nut. One can reverse the lever by switching the orientation when assembling.

## • SPECIFICATIONS

1. The rotational angle of the key is 90° between points **A** and **B**.
2. The key can be inserted or removed only at point **A**.  
(Two-point inserting locks are not available.)

## • PARTS LIST

No.	Part Name	Material	Finish	Qty.
1	Lock	Brass	Chrome Plated	1
2	Keys		Nickel Plated	2
3	Retainer for ...MTL348-1	Stainless Steel	—	1
	Attaching Nut for ...MTL348-2	Steel	Zinc Plated	
4	Rotational Control Cam			
5	Lever			
6	Lock Washer			
7	Hex Nut			

## 6

## • LOCKS

Catalog Number	Key No.	Net Weight g
MNBT31MTL348-1	348	40
MNBT31MTL348-2		

...MTL348-1

...MTL348-2

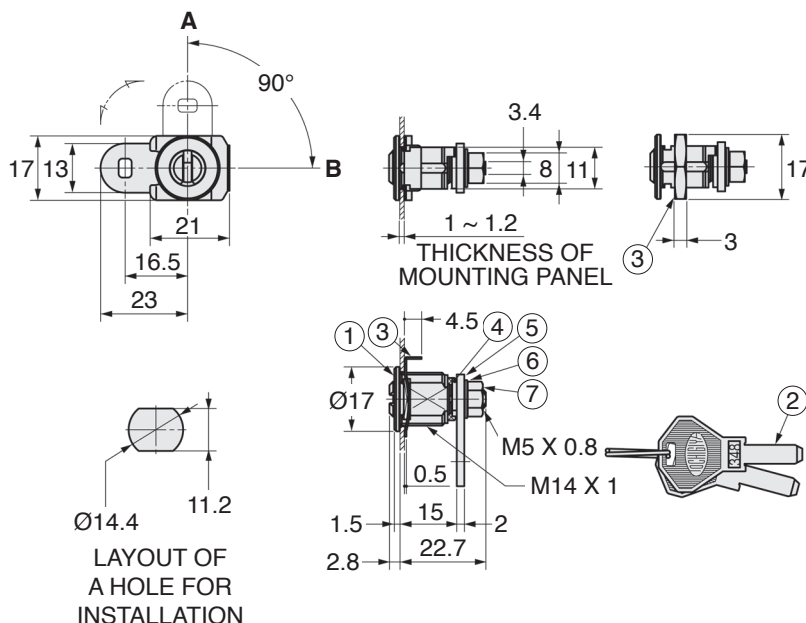

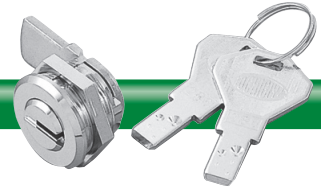

## • APPLICATIONS

Small control devices / Ticket machines / Information devices / Office automation devices

## • CHARACTERISTICS

It uses a reversible type key for smooth operation. Suitable for small spaces because of its compact design. The lever (4) is attached to the body which provides easy installation.

## • SPECIFICATIONS

1. The rotational angle of the key is 90° between points **A** and **B**.
2. The key can be inserted or removed only at point **A**.
3. The key number is identical for the locks in stock.
4. The lock can be installed as either a left- or right-sided lock.

## • PARTS LIST

No.	Part Name	Material	Finish	Qty.
1	Lock Body	Brass	Chrome Plated	1
2	Attaching Nut		Nickel Plated	2
3	Keys	Steel	Zinc Plated	2
4	Lever			1

6

## • LOCK

Catalog Number	Key No.	Net Weight g
MNBT04MTL286	286	40

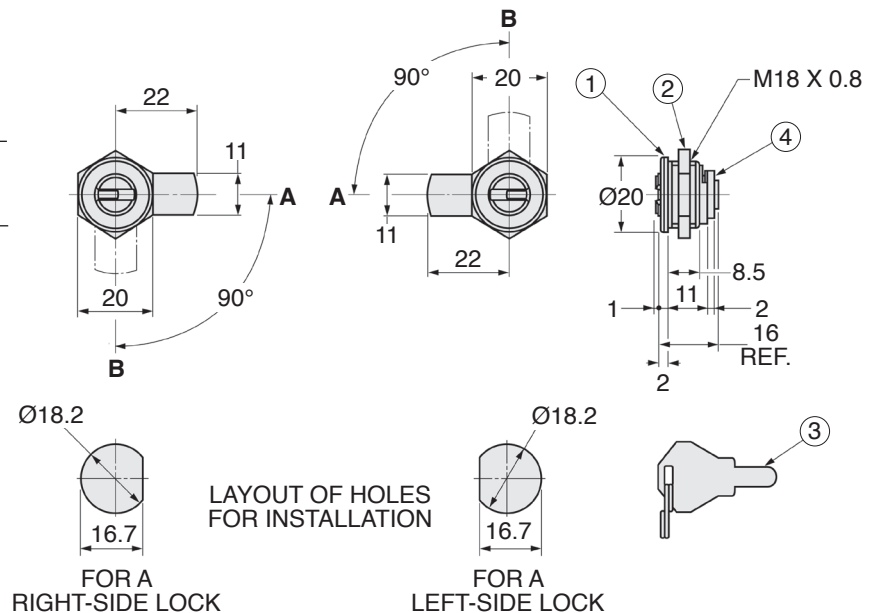

## LOCK, CAM, Short-Type

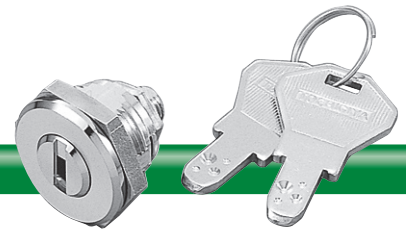

### • APPLICATIONS

Automatic vending machines / Ticket machines /  
Information devices / Office automation devices

### • CHARACTERISTICS

One of the locks in the ...**MTL247** series; the position of the lever is shortened by 4.1 mm, which is the same as cam lock ...**MTL110**. Since the lock uses a flat-type key, a large variety of keys are available unlike pin-type key locks.

### • SPECIFICATIONS

1. The rotational angle of the key is 90° between points **A** and **B**.
2. The key can be inserted or removed only at point **A**.  
(Two-point inserting locks are not available.)
3. The key number is identical for the locks in stock.

### • PARTS LIST

No.	Part Name	Material	Finish	Qty.
1	Lock Body	Brass	Chrome Plated	1
2	Keys		Nickel Plated	2
3	Large Nut			
4	Rotation Control Cam	Steel	Zinc Plated	1
5	Small Nut			
6	Washer			

## 6

### • LOCK

Catalog Number	Key No.	Net Weight g
<b>MNBT05MTL251</b>	251	43.2

LEVER  
(SOLD SEPARATELY)  
...**MTL96K**-. OR  
EQUIVALENT

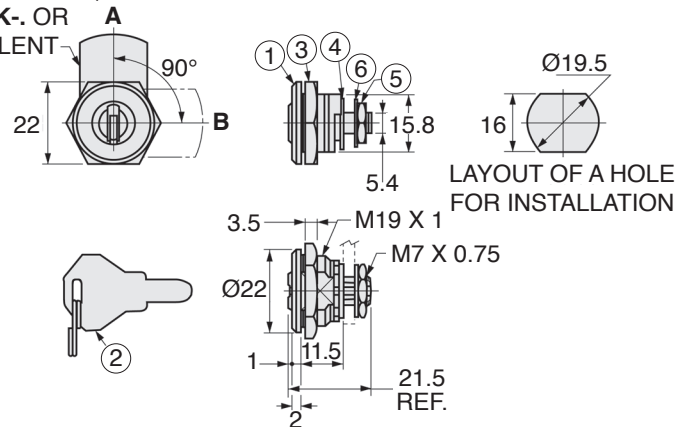

See last page in this section for Cam Lock Levers.



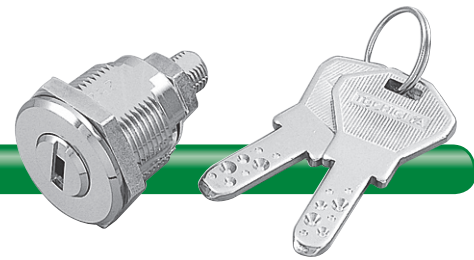

## • APPLICATIONS

Automatic vending machines / Ticket machines /  
Information devices / Office automation devices

## • CHARACTERISTICS

One of the locks in the **...MTL247** series; the position of the lever is lengthened by 1.8 mm, which is the same as cam lock **...MTL96**. The lock uses a reversible type key for smooth operation. It is suitable for small devices that have less extrusion on the mounting surface.

## • SPECIFICATIONS

1. The rotational angle of the key is 90° between points **A** and **B**.
2. The key can be inserted or removed only at point **A**.  
(Two-point inserting locks are not available.)
3. The key number is identical for the locks in stock.

## • PARTS LIST

No.	Part Name	Material	Finish	Qty.	
1	Lock Body	Brass	Chrome Plated	1	
2	Keys		Nickel Plated	2	
3	Large Nut	Steel	Zinc Plated	1	
4	Rotation Control Cam				
5	Small Nut		Bright Zinc Plated		
6	Washer				

## 6

## • LOCK

Catalog Number	Key No.	Net Weight g
<b>MNBT05MTL252</b>	252	56.8

LEVER  
(SOLD SEPARATELY)  
**...MTL96K- OR  
EQUIVALENT**

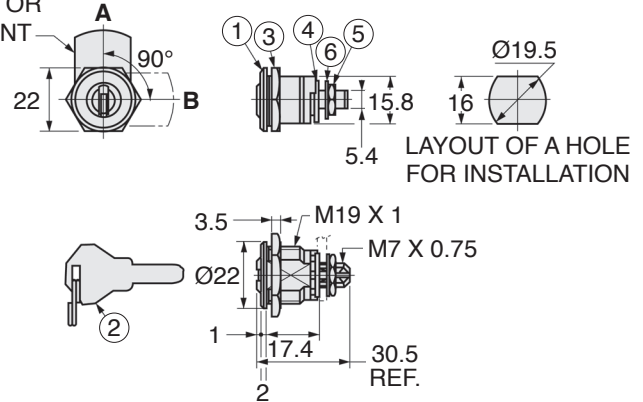

See last page in this section for Cam Lock Levers.

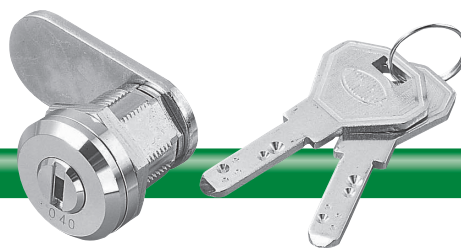

## • APPLICATIONS

Distribution boards / Distribution panels /  
Control boards

## • SPECIFICATIONS

1. The rotational angle of the key is 90° between points **A** and **B**.
2. The key can be inserted or removed at points **A** and **B**.

## • PARTS LIST

No.	Part Name	Material	Finish	Qty.
1	Lock	Zinc Die-Cast	Chrome Plated	1
2	Collar			
3	Wave Washer	Stainless Steel	—	
4	Attaching Nut	Steel	Zinc Plated	
5	Rotation Control Cam			
6	Lever			
7	Hex Nut	Brass	Nickel Plated	2
8	Keys			

## • LOCK

Catalog Number	Key* No.	Net Weight g
<b>MNBT33MTL326</b>	001 ~ 150	80

\*Key number is randomly assigned between 001~150 and cannot be specified.

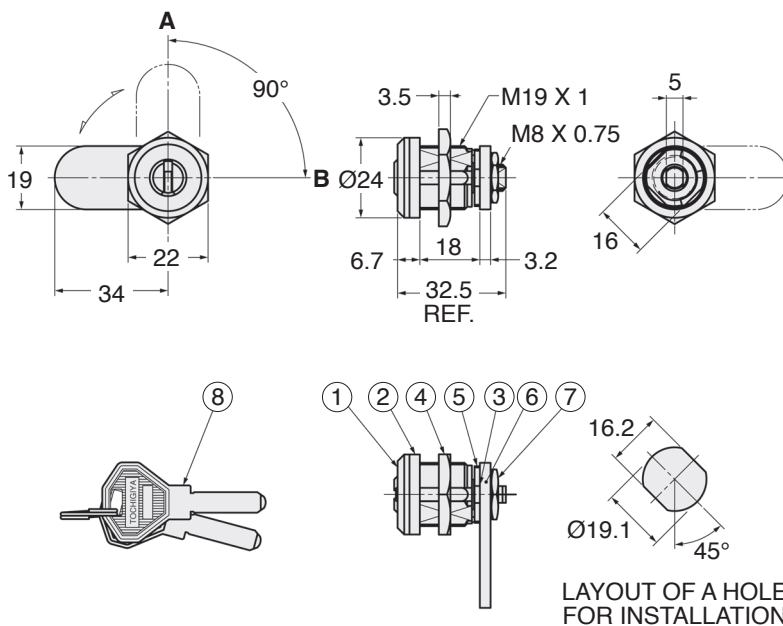

## LOCK, CAM - Reversible Key

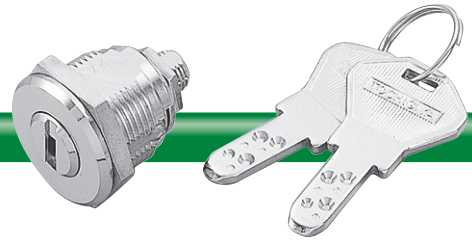

### • APPLICATIONS

Automatic vending machines / Ticket machines /  
Theft prevention devices

### • CHARACTERISTIC

The lock uses a reversible type key for smooth operation.

### • SPECIFICATIONS

1. The rotational angle of the key is 90° between points **A** and **B**.
2. The key can be inserted or removed only at point **A**.  
(Two-point inserting locks are not available.)
3. The key number is identical for the locks in stock.

### • PARTS LIST

No.	Part Name	Material	Finish	Qty.	
1	Lock Body	Brass	Chrome Plated	1	
2	Keys		Nickel Plated	2	
3	Large Nut	Steel	Zinc Plated	1	
4	Rotation Control Cam				
5	Small Nut		Bright Zinc Plated		
6	Washer				

### • LOCK

Catalog Number	Key No.	Net Weight g
<b>MNBT05MTL247</b>	247	52.2

6

LEVER  
(SOLD SEPARATELY)  
...MTL96K- OR  
EQUIVALENT

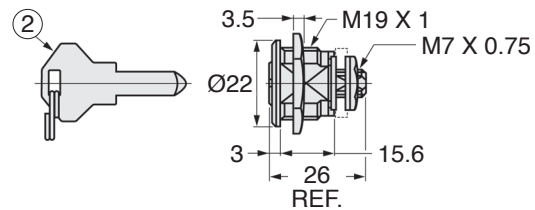
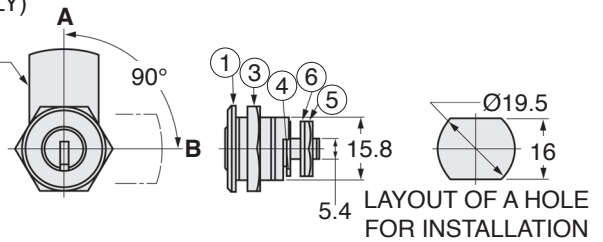

See last page in this section for Cam Lock Levers.

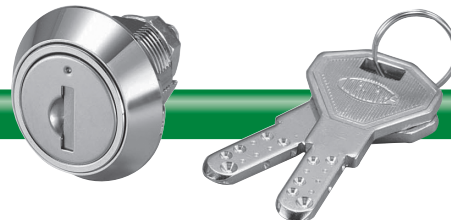

• **APPLICATIONS**

Automatic vending machines / Money exchanging machines /  
Facility access control

• **CHARACTERISTICS**

The cap and the shutter give this lock better dust and leak resistance. It's a double-row pin structure, making it tamper resistant. A rotatable ring is used to prevent tampering by twisting the lock.

• **SPECIFICATIONS**

1. The rotational angle of the key is 90° between points **A** and **B**.
2. The key can be inserted or removed only at point **A**.
3. The lever is sold separately.

• **PARTS LIST**

No.	Part Name	Material	Finish	Qty.
1	Lock Body	Brass / Zinc Die Cast	Chrome Plated / Zinc Plated	1
2	Keys	Brass	Nickel Plated	2
3	Case		Chrome Plated	1
4	Rotatable Ring			
5	Cap	Stainless Steel	—	
6	Large Nut	Carbon Steel	Zinc Plated	
7	Toothed-Lock Washer			
8	Rotation Control Cam	Steel		
9	Small Nut			

• **LOCK**

Catalog Number	Key No.	Net Weight g
MNBT30MTL353	353	85

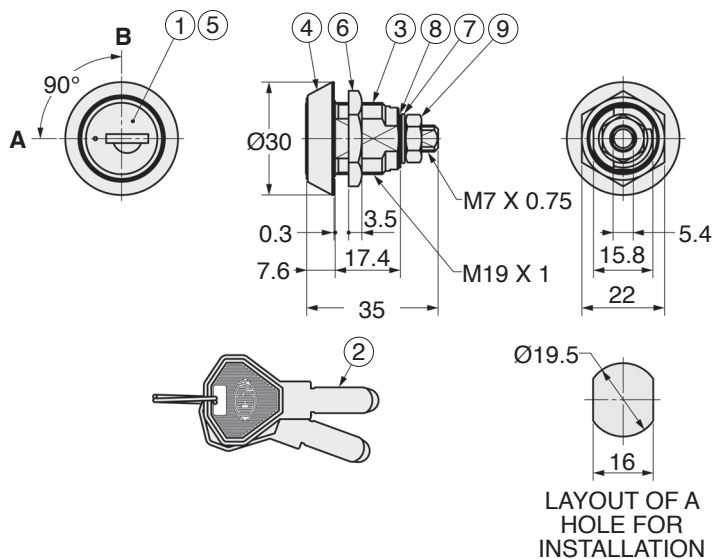

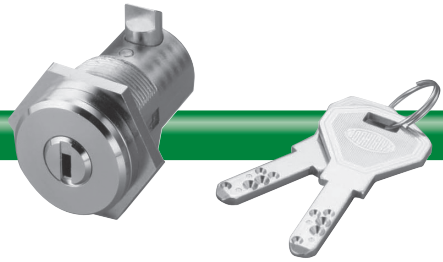

• **APPLICATIONS**

Small cabinet / Various small tools / Boxes

• **CHARACTERISTICS**

Can be locked without a key. For smooth operation, it is possible to use the same key as for ...**MTL326**. (available on special order)

• **SPECIFICATIONS**

1. Lock can opened between points **A** and **B** or between points **A** and **D**.
2. The key can be inserted or removed only at point **A**.

• **PARTS LIST**

No.	Part Name	Material	Finish	Qty.
1	Lock	Zinc Die Cast	Chrome Plated	1
2	Latch			
3	Spacer			
4	Attaching Nut	Carbon Steel	—	1
5	Latch Spring	Stainless Steel		
6	Keys	Brass	Nickel Plated	2

• **LOCK**

Catalog Number	Key* No.	Net Weight g
<b>MNBT32MTL347</b>	001 ~ 150	115

\*Key number is randomly assigned between 001~150 and cannot be specified.

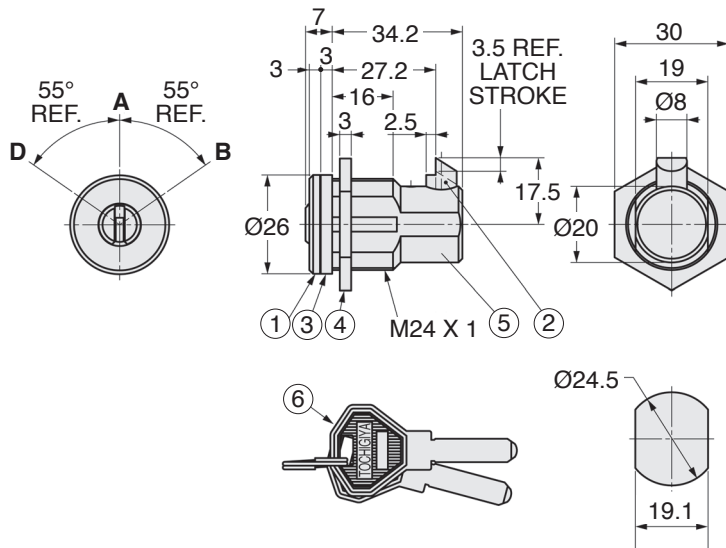

LAYOUT OF A HOLE  
FOR INSTALLATION

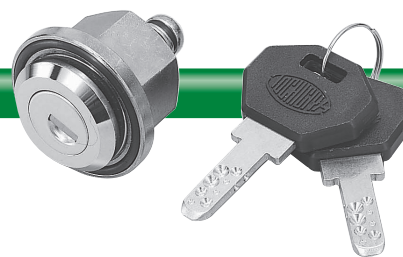

## • APPLICATIONS

## Distribution boards / Distribution panels / Control boards

- **CHARACTERISTIC**

The cam lock is waterproof.

## • SPECIFICATIONS

1. The rotational angle of the key is  $90^\circ$  between points **A** and **B**.
2. The key can be inserted or removed only at point **A**.

## • PARTS LIST

No.	Part Name	Material	Finish	Qty.
1	Body	Zinc Die Cast / Stainless Steel	Chrome Plated / Zinc Plated / –	1
2	Packing	Rubber	Black	
3	Attaching Nut	Zinc Die Cast	Zinc Plated	
4	Rotation Control Cam	Steel		
5	Pan Head Screw with Washer			
6	C-Shaped Snap Ring	Stainless Steel	—	2
7	Keys	Nickel Silver / Polypropylene	—	

6

- LOCK

Catalog Number	Key No.	Applicable Panel Thickness	Net Weight g
MNBT01MTL324	E5000	1.4 ~ 3.2	87.3

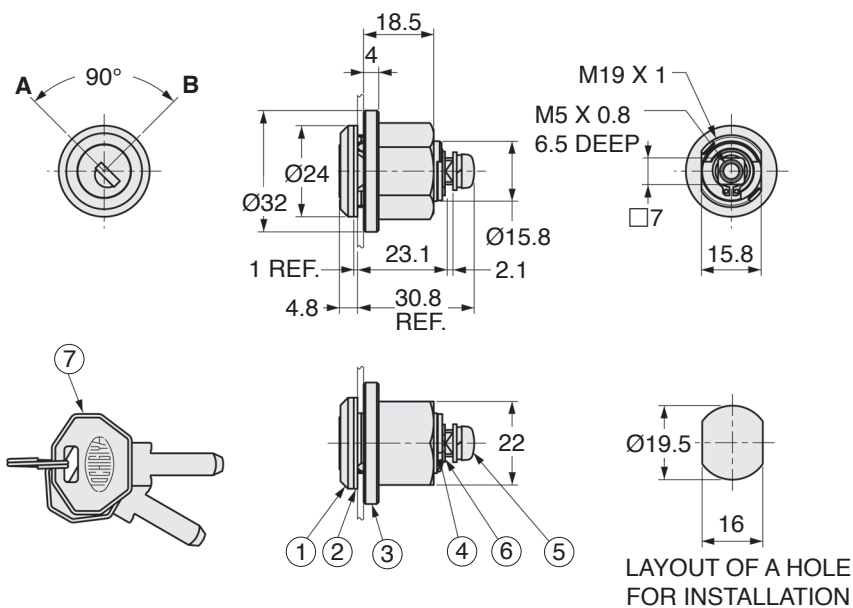

## LOCK, CAM, Ball-Type Key

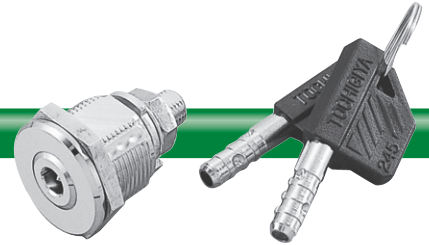

### • APPLICATIONS

Automatic vending machines / Ticket machines /  
Theft prevention devices

### • CHARACTERISTIC

The installation method is compatible to that of the ...**MTL96**. series. However, the innovative design of the ball-type key provides exceptional operability and security, which is suitable for antitheft devices. The unique design structure makes the lock highly tamper-resistant.

### • SPECIFICATIONS

1. The rotational angle of the key is 90° between points **A** and **B**.
2. The key can be inserted or removed only at point **A**.  
(Two-point inserting locks are not available.)
3. The key number is identical for the locks in stock.

### • PARTS LIST

No.	Part Name	Material	Finish	Qty.
1	Lock Body	Brass	Chrome Plated	1
2	Keys	Brass / ABS	Nickel Plated / Black	2
3	Large Nut	Steel	Zinc Plated	1
4	Small Nut		Bright Zinc Plated	
5	Rotation Control Cam			
6	Washer			

### • LOCK

Catalog Number	Key No.	Net Weight g
<b>MNBT03MTL245</b>	245	50.8

6

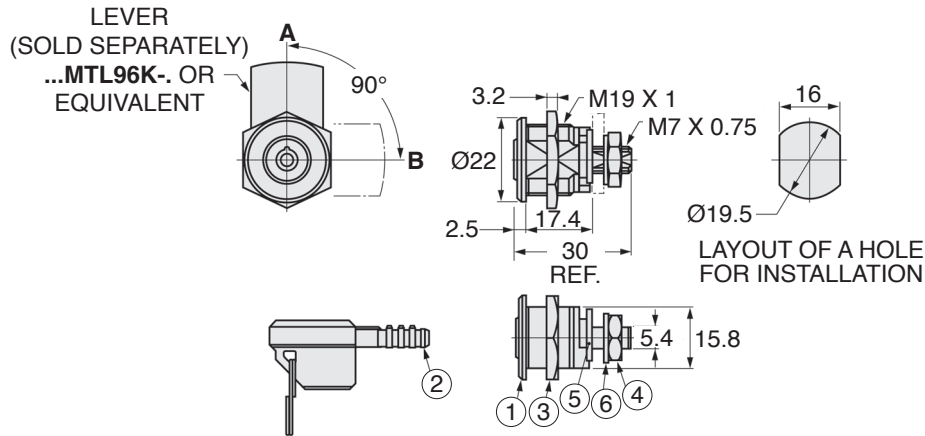

See last page in this section for Cam Lock Levers.





## LOCKS, KEY WRENCH-OPERATED

RoHS  
COMPLIANT

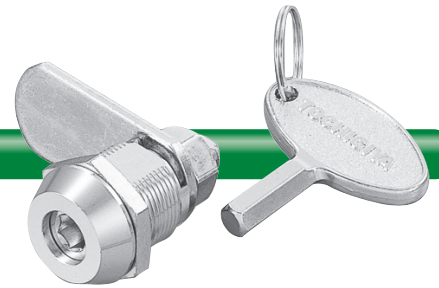

### • APPLICATIONS

Machine tools / Distribution panels

### • CHARACTERISTIC

This simple latch utilizes a hexagonal wrench key.

### • LOCKS

Catalog Number	Name	Net Weight g
MNBT20MTL193-1	Wrench-Operated Lock	69.4
MNBT20MTL193-2	Key Wrench	16.4

ΔThe key wrench is sold separately.

### • PARTS LIST

No.	Part Name	Material	Finish	Qty.
1	Cylinder	Brass	Chrome Plated	1
2	Shaft	Zinc Die Cast	Chrome Plated	
3	Mounting Nut		Zinc Plated	
4	*Key Wrench		Nickel Plated	—
5	Cam	Steel	Zinc Plated	1
6	Lever		Zinc Plated	
7	Nut		Zinc Plated	
8	Washer	Stainless Steel	—	

\*The key wrench is sold separately.

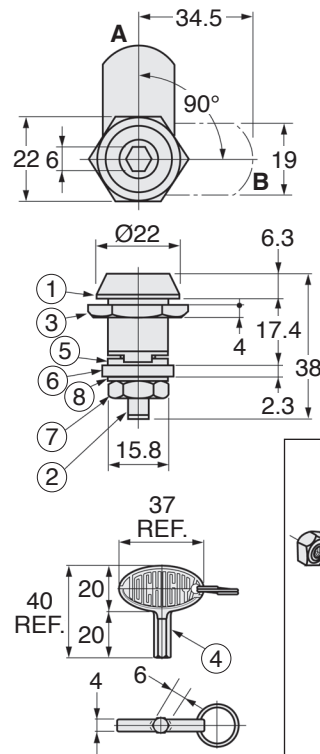

### LAYOUT OF HOLE FOR INSTALLATION

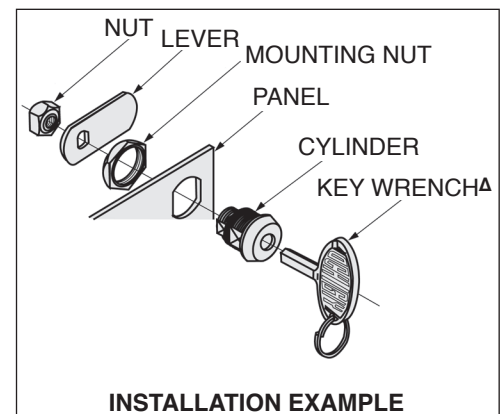
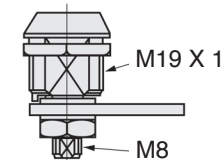
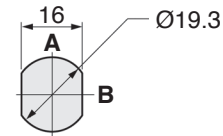

## LOCK, CAM - Handle Key Type



## • APPLICATIONS

Small control boards / Switch boxes / Various types of storage boxes

- **CHARACTERISTIC**

A keyhole is set at the lower part of the body and is invisible from the front, making the lock tamper-resistant.

## • SPECIFICATIONS

1. The operational angle of the key is  $80^\circ$  between points **A** and **B**.
2. The key can be inserted and removed only at point **A**.
3. By reversing the rotation control cam front to back, the operational angle of the key becomes  $80^\circ$  between points **A** and **D**.
4. It has detent mechanisms at point **A** and **B(D)**.

## • PARTS LIST

No.	Part Name	Material	Finish	Qty.
1	Lock Body	Zinc Die Cast	Chrome Plated	1
2	Key		Nickel Plated	
3	Attaching Nut	Steel	Zinc Plated	
4	Toothed Lock Washer			
5	Hexagonal Nut			
6	Lever			
7	Spacer		Bright Zinc Plated	
8	Rotating Control Cam			

## 6

- **LOCK**

Catalog Number	Key No.	Net Weight g
MNBT21MTL293	293	47

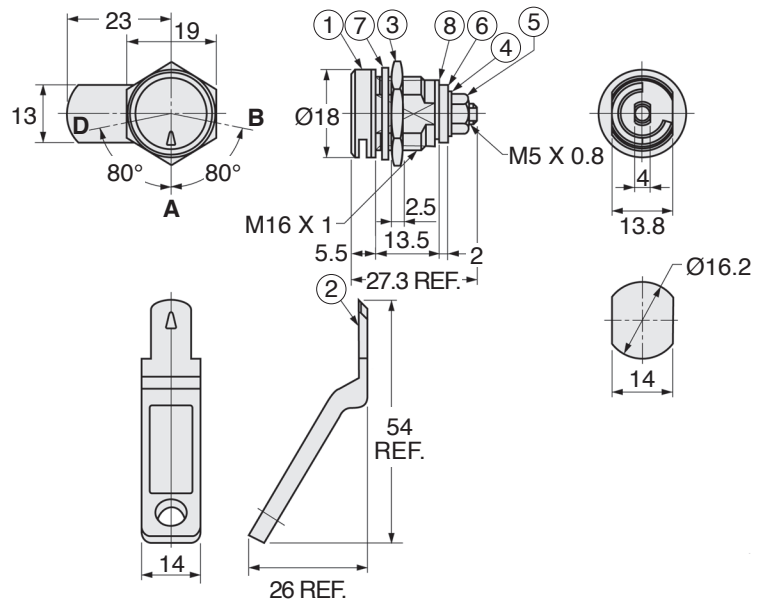

## LOCK, CAM - Circular Keyway, Miniature

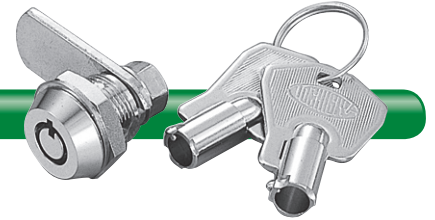

### • APPLICATIONS

Office automation appliances / Information devices / Automatic vending machines / Theft-detering devices

### • CHARACTERISTICS

The miniature cam lock is two sizes smaller than the ordinary pipe-key type cam lock. The diameter of the cylinder style key is even smaller than the width of a plate-key type cylinder lock. It performs and functions completely the same as the larger cam model and is also tamper- and theft-resistant.

### • SPECIFICATIONS

1. The rotational angle of the key is 90° between points **A** and **B**.
2. The key can be inserted or removed only at point **A**.
3. The key number is identical for all the locks in stock.

### • PARTS LIST

No.	Part Name	Material	Finish	Qty.
1	Lock Body	Brass	Chrome Plated	1
2	Attaching Nut	Steel	Zinc Plated	
3	Hexagonal Nut			
4	Lever			
5	Toothed Washer			
6	Spacer			
7	Keys	Brass / Steel	Nickel Plated	2

## 6

### • LOCK

Catalog Number	Key No.	Net Weight g
MNBT17MTL225	225	31.4

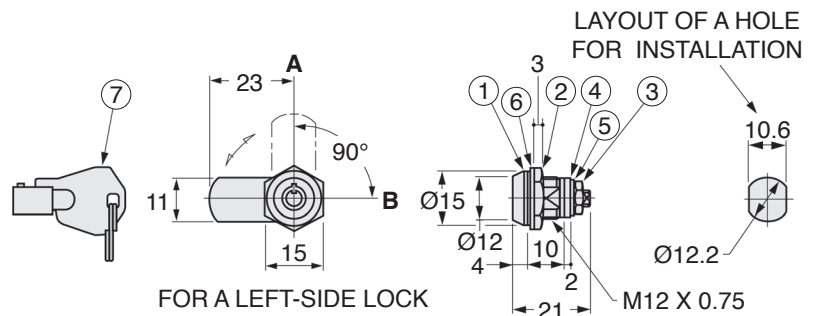

## LOCK, CAM - Circular Keyway, Small

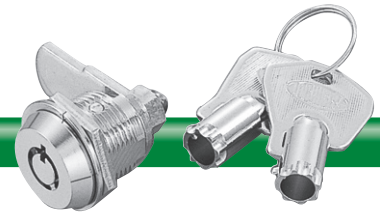

### • APPLICATIONS

Office automation appliances / Information devices / Automatic vending machines / Theft-detering devices

### • CHARACTERISTICS

Because the cam is one size smaller than the ordinary pipe-key type cam lock, it is ideal for smaller sized devices. It performs and functions completely the same as the larger cam model and is also tamper- and theft-resistant.

### • SPECIFICATIONS

1. The rotational angle of the key is 90° between points **A** and **B**.
2. The key can be inserted or removed only at point **A**.
3. The key number is identical for all the locks in stock.

### • PARTS LIST

No.	Part Name	Material	Finish	Qty.
1	Lock Body	Brass	Chrome Plated	1
2	Attaching Nut	Steel	Zinc Plated	
3	Hexagonal Nut			
4	Rotation Control Cam			
5	Lever			
6	Toothed Washer			
7	Spacer			
8	Keys	Brass / Steel	Nickel Plated	2

6

### • LOCK

Catalog Number	Key No.	Net Weight g
MNBT17MTL224	224	45.8

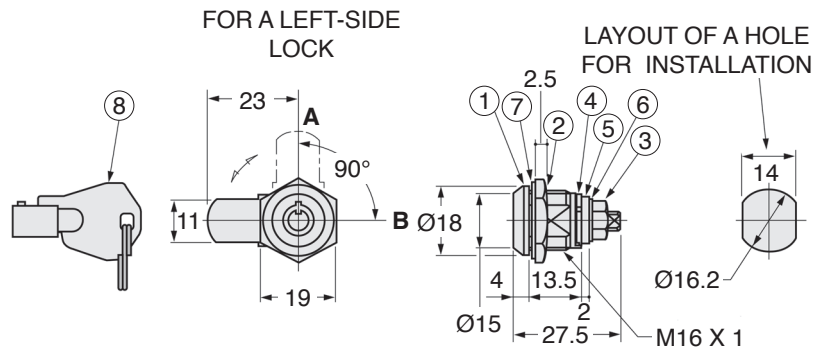

## LOCKS, CAM - Circular Keyway



### • APPLICATIONS

Automatic vending machines / Ticket vending machines /  
Exchange machines

### • CHARACTERISTICS

Model ...**MTL96S-1** has a shorter cam than model ...**MTL96L**.  
The lock is specialized for limited space applications and is tamper-  
and theft-resistant. Keys are supplied for controlled access.

### • SPECIFICATIONS

1. The rotational angle of the key is 90°, between points **A** and **B**.
2. The key can be inserted or removed only at point **A**.
3. Custom-made keys are available on special request.

Fig. 1

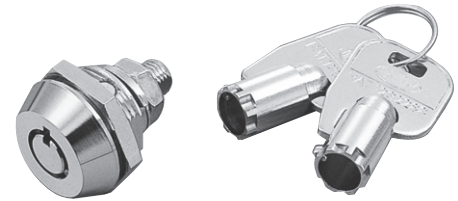

Fig. 2



Fig. 1 • LOCK - Short

Catalog Number	Key No.	Net Weight g
<b>MNBT07MTL96S-1</b>	G3401	62

Fig. 2 • LOCK - Long

Catalog Number	Key No.	Net Weight g
<b>MNBT07MTL96L</b>	K1161	95.6

### • PARTS LIST

No.	Part Name	Material	Finish	Qty.
1	Lock	Brass	Chrome Plated	1
2	Attaching Nut	Steel	Zinc Plated	
3	Hexagonal Nut			
4	Keys	Carbon Steel / Steel	Nickel Plated	2

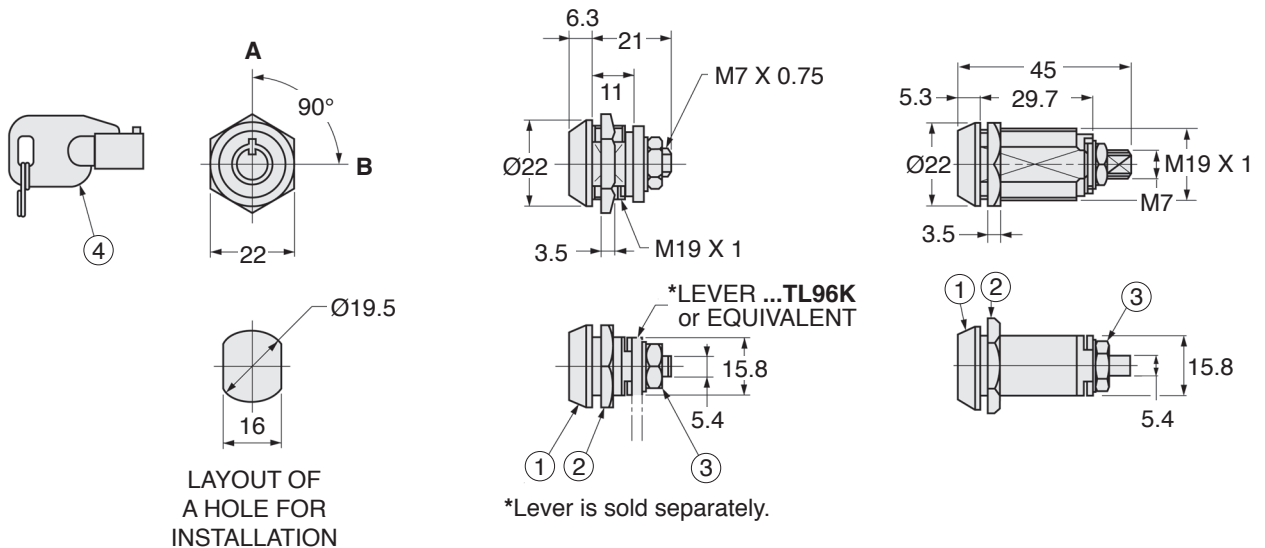
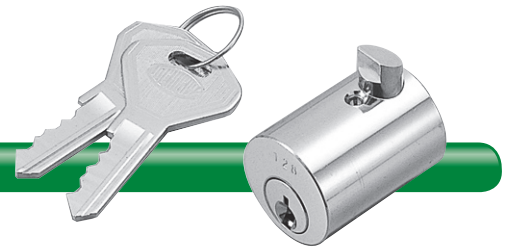

Fig. 1

Fig. 2

See last page in this section for Cam Lock Levers.



• **APPLICATIONS**

Boxes / Tables

• **CHARACTERISTIC**

The lock contains a spring loaded mechanism.

• **SPECIFICATIONS**

1. The unit will lock without a key.
2. Both clockwise (**A** to **B**) and counterclockwise (**A** to **D**) rotations will lock the unit.
3. The key can be inserted and removed only at point **A**.

• **PARTS LIST**

No.	Part Name	Material	Finish	Qty.
1	Key Body	Brass	Chrome Plated	1
2	Latch		Nickel Plated	2
3	Keys	Stainless Steel	—	1
4	Coil Spring		—	1

• **LOCK**

Catalog Number	Key No.	Net Weight g
<b>MNBT24MTL128</b>	128	100.4

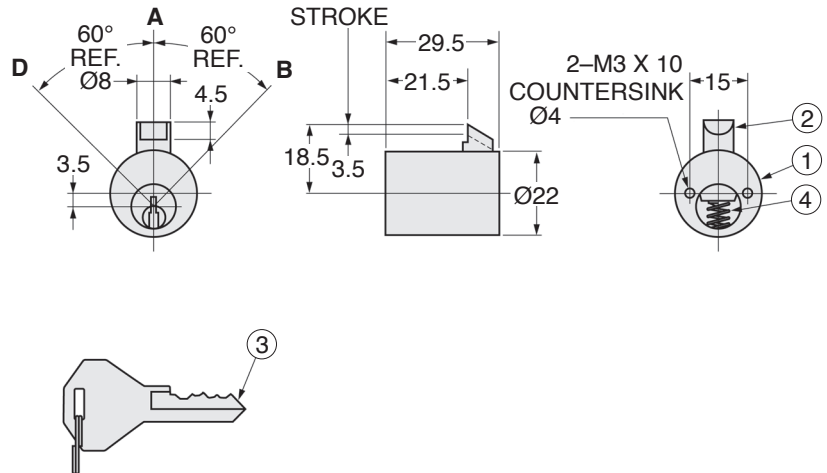

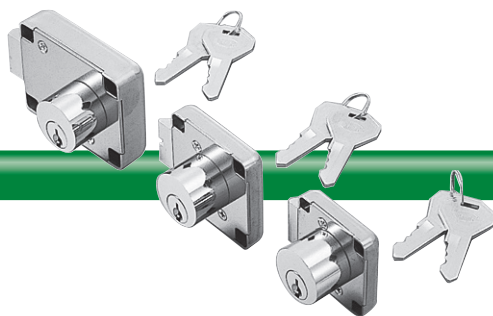



#### • APPLICATIONS

Distribution boards / Distribution panels / Control boards /  
Storage boxes on vehicles / Transporter cases / Various types  
of storage cases

#### • CHARACTERISTICS

This very professional looking lock has secure locking and anti-vibration mechanisms built in, preventing unintentional opening from vibration and shock. The minitype tubular cylinder lock also improves antitheft protection.

#### • INSTALLATION

The strike plate and strike plate base should be attached on the same level plane. Normal operation or proper locking may not occur if there is a gap between the two attaching planes.

#### • PARTS LIST

No.	Part Name	Material	Finish	Qty.
1	Catch Lever	Stainless Steel	Barrel Polishing	1
2	Catch Base			
3	Spring		—	
4	Strike Plate Base	Aluminum	Trivalent Chromate Coating	
5	Strike Plate			
6	Lock Assembly	Brass	Chrome Plated	2
7	Key	Steel / Brass	Nickel Plated	

#### • LOCK

Catalog Number	Tightening Force N (kgf)	Key No.	Net Weight g
<b>MNBT00MTL300B</b>	Approx. 32.4 (3.3)	300B	102

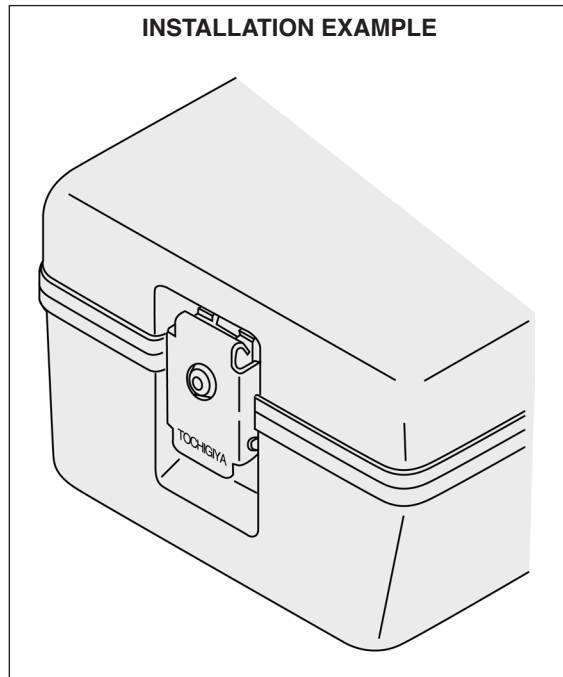
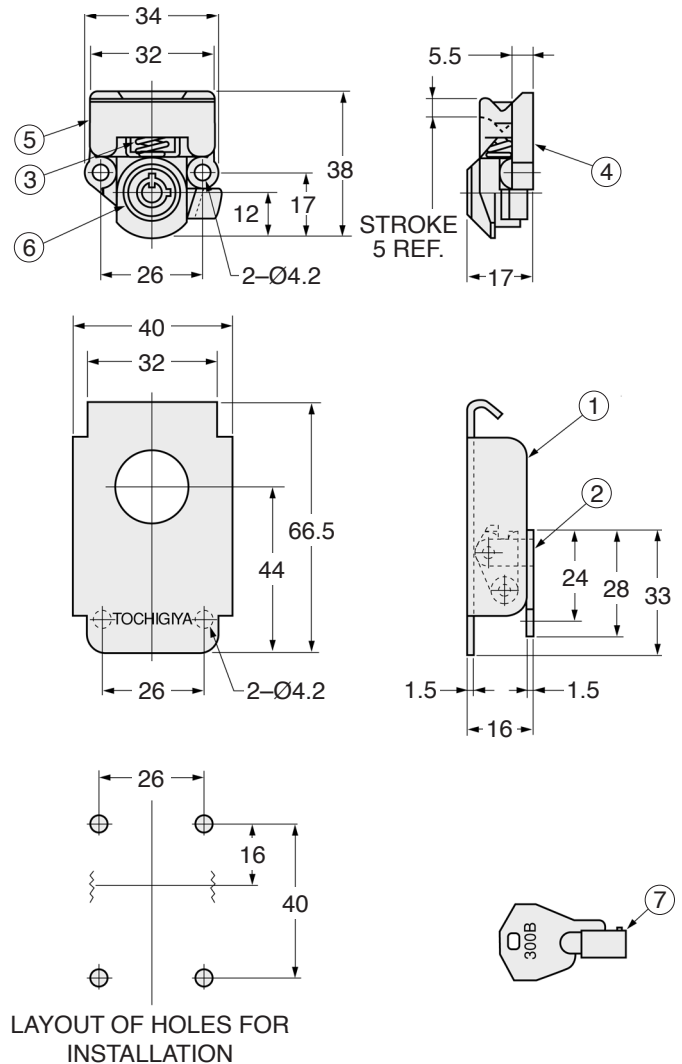



## LOCK, CAM - Automatic Latching

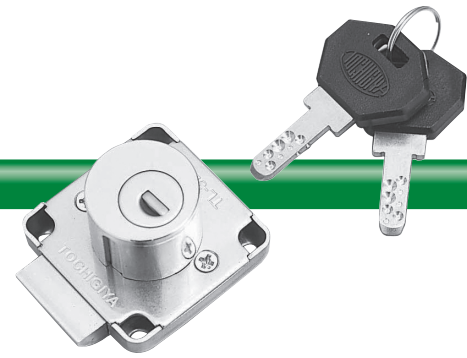

### • APPLICATIONS

Distribution boards / Distribution panels / Control boards

### • CHARACTERISTIC

Simply close the door to lock. The key is used for opening the door only. After the key is turned, it will return to the insertion point by its automatic return mechanism.

### • SPECIFICATIONS

1. The rotational angle of the key is 32° between points **A** and **B**.
2. The key can be inserted or removed only at point **A**.

### • PARTS LIST

No.	Part Name	Material	Finish	Qty.
1	Body	Zinc Die Cast / Stainless Steel	Zinc Plated / Chrome Plated / -	1
2	Case	Stainless Steel	Barrel Polishing	
3	Cover		Chrome Plated	
4	Latch	Brass	Nickel Plated	2
5	Spacers			1
6	Latch Stopper Pin			2
7	Keys	Nickel Silver / Polypropylene	Nickel Plated / Black	

### • LOCK

Catalog Number	Key No.	Net Weight g
MNBT02MTL325	E5000	136

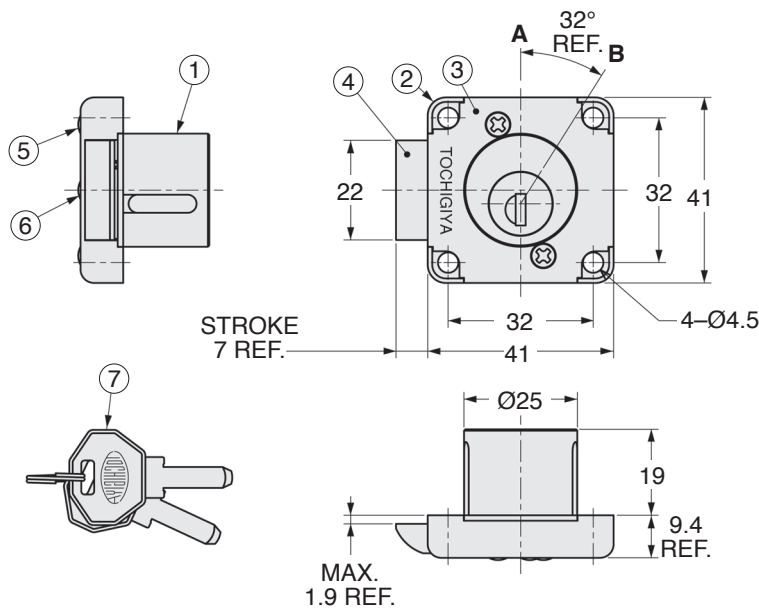

## LATCHES, SOLENOID



### • APPLICATIONS

Distribution boards / Distribution panels / Control boards / Lockers

### • CHARACTERISTIC

To operate the solenoid latch, push the door in to close position and use the power switch to open. In case of an emergency, models ...MTL258-1 and ...MTL259-1 have keys to mechanically open the lock.

### • SWITCH PERFORMANCE

Switch	Solenoid
On	Latch is pulled in (unlocked position)
Off	Latch is in locking position

### • GENERAL DESCRIPTION OF SOLENOID

	...MTL258	...MTL259
Rated Voltage	DC 24V (Continuous Rating)	
Power Consumption	3W	5W
Holding Force N (kgf)	0.98 (0.1) ~ 6.87 (0.7)	1.96 (0.2) ~ 15.7 (1.6)

### • LATCHES

Catalog Number	Specifications	Net Weight g
MNBT29MTL258-1	With Key	128.1
MNBT29MTL258-2	Without Key	85
MNBT29MTL259-1	With Key	249.8
MNBT29MTL259-2	Without Key	221.8

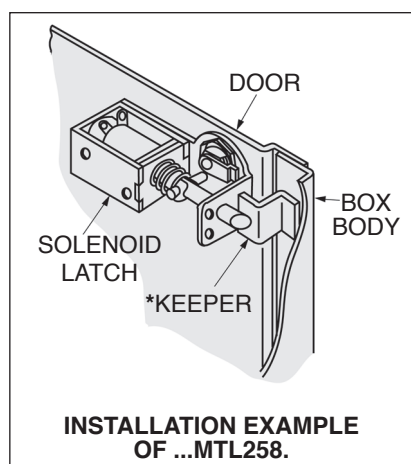

\*Not supplied

### • PARTS LIST

No.	Part Name	Material	Finish	Qty.
1	Base	Steel	Zinc Plated	1
2	Countersunk Screw			
3	E-Ring	Stainless Steel	—	
4	Latch			
5	Spring Pin			
6	Spring			
7	Solenoid	—	Chrome Plated	
8	Lock	Brass		

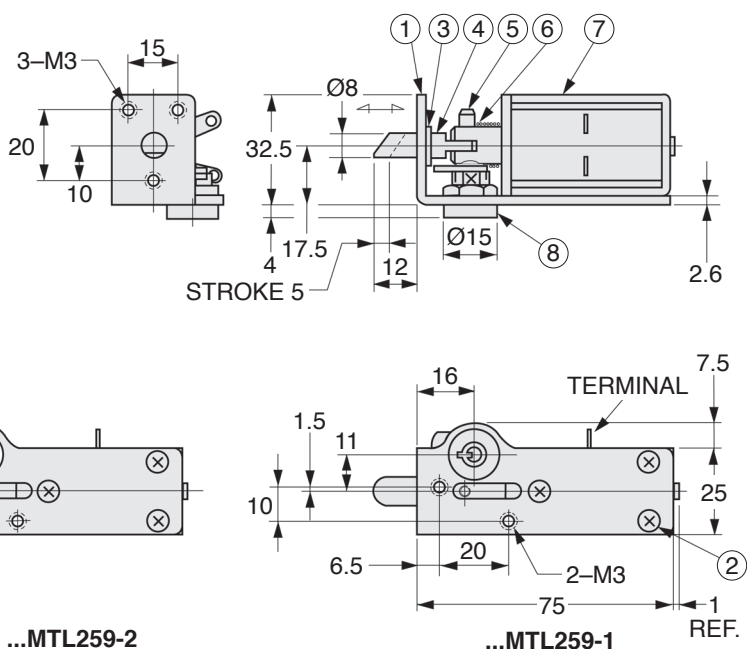
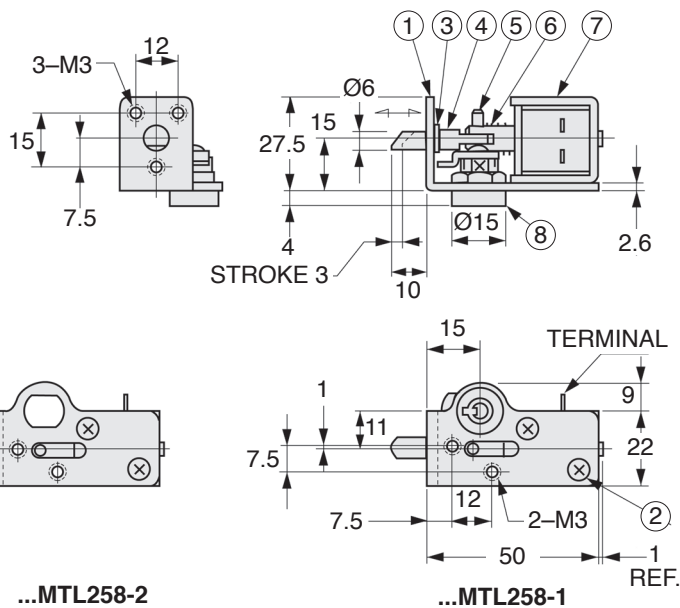

## LOCK, CAM - Key Switch



### • APPLICATIONS

Measuring instruments / Office automation devices

### • CHARACTERISTIC

A tubular cylinder lock.

### • SPECIFICATIONS



1. The key can be inserted or removed only at point **A**.
2. The key number is identical for the locks in stock.

### • LOCK

Catalog Number	Key No.	Net Weight g
MNBT27MTL155	E6431	99.8

6

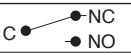
### • KEY INSERT AND CONTACT FORM OF MICROSWITCH

Position	Contact Form	Key Insert
Point A		YES
Point B		NO

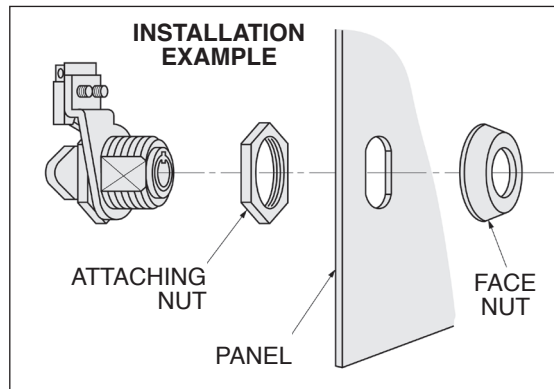

### • PARTS LIST

No.	Part Name	Material	Finish	Qty.
1	Keys	Steel	Nickel Plated	2
2	Bracket		Zinc Plated	1
3	Washers			2
4	Pan Head Screws			
5	Attaching Nut		Bright Zinc Plated	1
6	Nut			
7	Internal Lock Washer	Spring Steel	Zinc Plated	2
8	Stopper Cam			
9	Spring Washers	Brass	Chrome Plated	1
10	Face Nut		Nickel Plated	
11	Lock		—	
12	Switch Cam	Varnished Cloth	—	1
13	Microspacer			
14	Microswitch	—	—	—

### • GENERAL PROPERTIES OF MICROSWITCH

<b>Product Name</b>	Matsushita Electric Works FS-T Model Microswitch AVL-3225
<b>Type</b>	Single-Pole Switching
<b>Terminal</b>	Plate Solder Terminal
<b>Rating</b>	250V AC 5A, 30V DC 5A, 125V DC 0.4A (Resistance Load COS $\phi \geq 1$ )
<b>Mechanical Life Expectancy</b>	Over 10,000,000 Operations (60 Operations/Min)
<b>Electrical Life Expectancy</b>	Over 50,000 Operations (20 Operations/Min) (Rated Load)
<b>Insulation Resistance</b>	100M $\Omega$ Min. (At 500V DC) with Insulation-Resistance Tester
<b>Dielectric Strength</b>	1,000V AC for 1 Min Between Noncontinuous Terminals. 1,500V AC for 1 Min Between Each Terminal and Terminal on Noncurrent-Carrying Metal. 1,500V AC for 1 Min Between Current-Carrying Metal Part and Ground.
<b>Contact Resistance</b>	Initial Value 50m $\Omega$ Max. (6 to 8V DC 1A with Voltage Drop Method)
<b>Operating Temperature</b>	-25°C to 80°C (Providing there is no Icing)
<b>Operating Humidity</b>	85% Max.

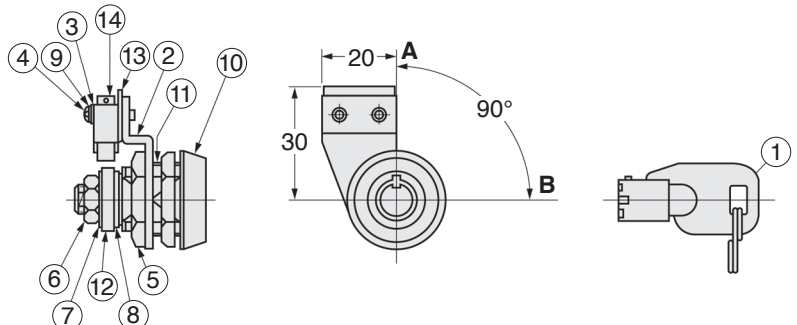
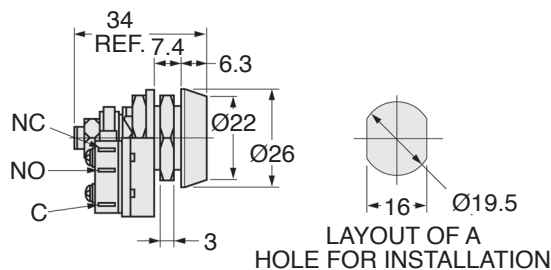

## LOCK, CAM - Key Switch



### • APPLICATIONS

Measuring instruments / Office automation devices

### • CHARACTERISTIC

The lock has a key switch with an automatic return mechanism.

### • SPECIFICATIONS









1. The key can be inserted or removed only at point **A**.
2. The return mechanism engages anywhere between points **B** and **C**. Once the key is turned to point **C**, it automatically returns to point **B**.
3. The key number is identical for the locks in stock.

### • LOCK

Catalog Number	Key No.	Net Weight g
MNBT25MTL143	143	199.6

6

### • CONTACT FORM OF MICROSWITCHES

Position	MS-1	MS-2	MS-3
Point A			
Point B			
Point C			

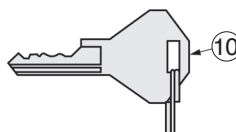
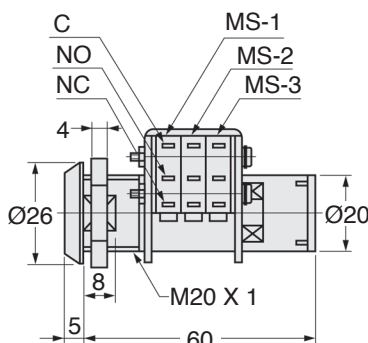
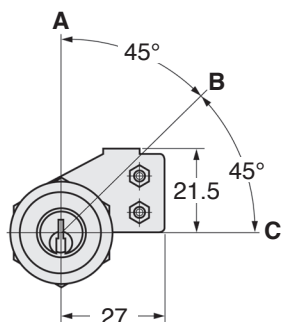
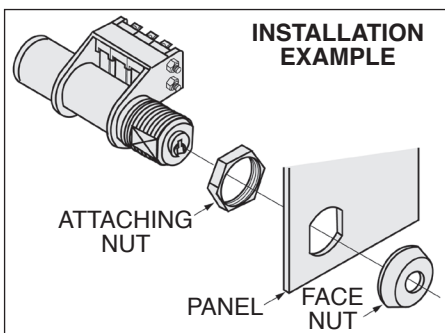

LAYOUT OF A HOLE FOR INSTALLATION

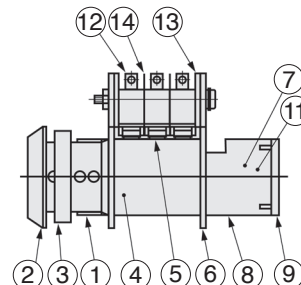

### • PARTS LIST

No.	Part Name	Material	Finish	Qty.
1	Lock Body	Brass	Chrome/Nickel Plated*	1
2	Face Nut		Chrome Plated	
3	Attaching Nut		Nickel Plated	
4	Cam			
5	Pins			
6	Bracket for Switch			
7	Return Shaft			
8	Holder		1	
9	Cover			
10	Keys		2	
11	Spring	Stainless Steel		
12	Microswitches	—		3
13	Insulator	Fiber		
14	Insulator	Varnished Cloth	2	

\*Chrome Plated Cylinder and Nickel Plated Case.

### • GENERAL PROPERTIES OF MICROSWITCHES

Product Name	Matsushita Electric Works FS-T Model Microswitch AVL-3225
Type	Single-Pole Switching
Terminal	Plate Solder Terminal
Rating	250V AC 5A, 30V DC 5A, 125V DC 0.4A (Resistance Load COS $\phi \geq 1$ )
Mechanical Life Expectancy	Over 10,000,000 Operations (60 Operations/Min)
Electrical Life Expectancy	Over 50,000 Operations (20 Operations/Min) (Rated Load)
Insulation Resistance	100M $\Omega$ Min. (At 500V DC) with Insulation-Resistance Tester
Dielectric Strength	1,000V AC for 1 Min Between Noncontinuous Terminals. 1,500V AC for 1 Min Between Each Terminal and Terminal on Noncurrent-Carrying Metal. 1,500V AC for 1 Min Between Current-Carrying Metal Part and Ground.
Contact Resistance	Initial Value 50m $\Omega$ Max. (6 to 8V DC 1A with Voltage Drop Method)
Operating Temperature	-25°C to 80°C (Providing there is no Icing)
Operating Humidity	85% Max.

## LOCKS, CAM - Key Switch



### • APPLICATIONS

Measuring instruments / Office automation devices

### • CHARACTERISTIC

Easy installation

### • SPECIFICATIONS

1. The rotational angle of the key is 90° between points **A** and **B**.
2. The key can be inserted or removed only at point **A**.
3. The key number is identical for the locks in stock.

### • LOCKS

Catalog Number	L	Key No.	Net Weight g
MNBT26MTL142-1	29	142	93.6
MNBT26MTL142-2	35.5		100.8
MNBT26MTL142-3	42		108.4

### • CONTACT FORM OF MICROSWITCHES

Position	MS-1	MS-2	MS-3
Point A	C ● NC ● NO	C ● NC ● NO	C ● NC ● NO
Point B	C ● NC ● NO	C ● NC ● NO	C ● NC ● NO

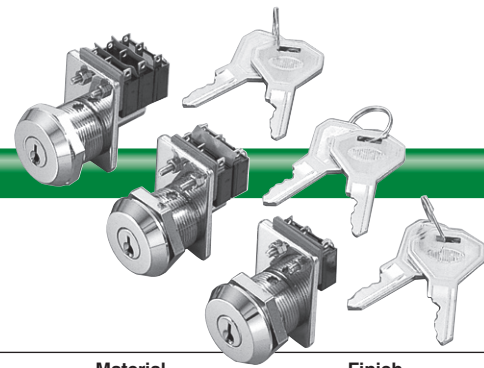
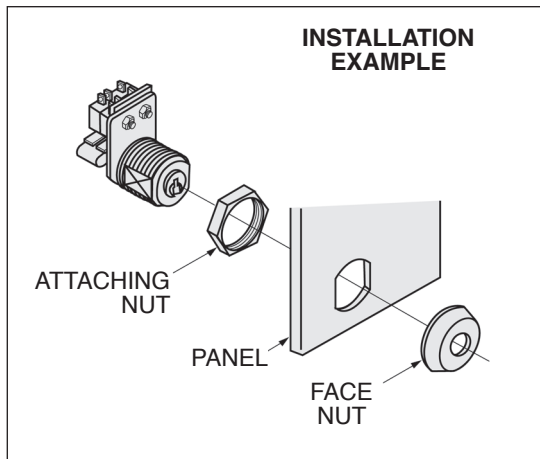

### • PARTS LIST

No.	Part Name	Material	Finish	Qty.
1	Keys	Brass	Nickel Plated	2
2	Bracket For Switch			1
3	Attaching Nut			
4	Cam			
5	Face Nut		Chrome Plated	
6	Lock Body			
7	Insulators	Fiber	—	2
8	Insulator(s)	Varnished Cloth		*
9	Microswitch(es)	—		**

\* Quantity of Insulators for Model: ...MTL142-1 is n/a, ...MTL142-2 is 1, ...MTL142-3 is 2.

\*\* Quantity of Microswitches for Model: ...MTL142-1 is 1, ...MTL142-2 is 2, ...MTL142-3 is 3.

### • GENERAL PROPERTIES OF MICROSWITCHES

Product Name	Matsushita Electric Works FS-T Model Microswitch AVL-3225
Type	Single-Pole Switching
Terminal	Plate Solder Terminal
Rating	250V AC 5A, 30V DC 5A, 125V DC 0.4A (Resistance Load COS $\phi \geq 1$ )
Mechanical Life Expectancy	Over 10,000,000 Operations (60 Operations/Min)
Electrical Life Expectancy	Over 50,000 Operations (20 Operations/Min) (Rated Load)
Insulation Resistance	100M $\Omega$ Min. (At 500V DC) with Insulation-Resistance Tester
Dielectric Strength	1,000V AC for 1 Min Between Noncontinuous Terminals. 1,500V AC for 1 Min Between Each Terminal and Terminal on Noncurrent-Carrying Metal. 1,500V AC for 1 Min Between Current-Carrying Metal Part and Ground.
Contact Resistance	Initial Value 50m $\Omega$ Max. (6 to 8V DC 1A with Voltage Drop Method)
Operating Temperature	-25°C to 80°C (Providing there is no Icing)
Operating Humidity	85% Max.

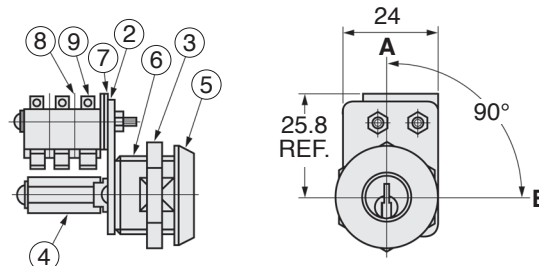
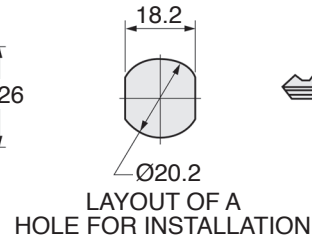
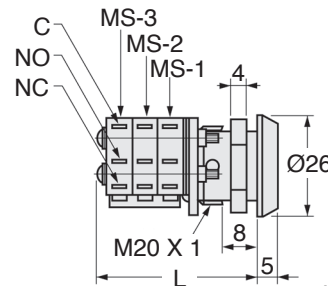

MODEL ...MTL142-3 SHOWN

## LOCK, CAM - Key Switch

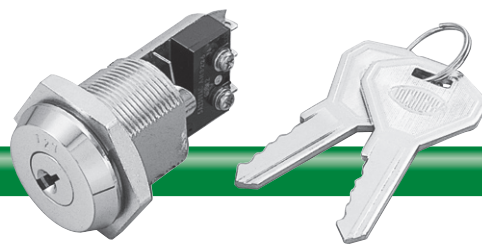

### • APPLICATIONS

Measuring instruments / Office automation devices / Information devices

### • CHARACTERISTICS

Room saving design with its streamlined appearance. Since the microswitch is unified with the body, installation can be made simply with a nut.

### • SPECIFICATION

I. The key can be inserted or removed at points **A** and **B**.

### • LOCK

Catalog Number	Key No.	Net Weight g
MNBT28MTL127	127	112.6

### • PARTS LIST

No.	Part Name	Material	Finish	Qty.
1	Keys	Brass	Nickel Plated	2
2	Attaching Nut			
3	Lock Body		Chrome Plated	1
4	Microswitch	—	—	
5	Pan Headed Screws	Steel	Zinc Plated	2
6	Washers			

### • GENERAL PROPERTIES OF THE MICROSWITCH

Product Name	Matsushita Electric Works FS-T Model Microswitch AVL-3225
Type	Single-Pole Switching
Terminal	Plate Solder Terminal
Rating	250V AC 5A, 30V DC 5A, 125V DC 0.4A (Resistance Load COS $\phi \geq 1$ )
Mechanical Life Expectancy	Over 10,000,000 Operations (60 Operations/Min)
Electrical Life Expectancy	Over 50,000 Operations (20 Operations/Min) (Rated Load)
Insulation Resistance	100M $\Omega$ Min. (At 500V DC) with Insulation-Resistance Tester
Dielectric Strength	1,000V AC for 1 Min Between Noncontinuous Terminals. 1,500V AC for 1 Min Between Each Terminal and Terminal on Noncurrent-Carrying Metal. 1,500V AC for 1 Min Between Current-Carrying Metal Part and Ground.
Contact Resistance	Initial Value 50m $\Omega$ Max. (6 to 8V DC 1A with Voltage Drop Method)
Operating Temperature	-25°C to 80°C (Providing there is no Icing)
Operating Humidity	85% Max.

6

### • CONTACT FORM OF THE MICROSWITCH

Position	
Point A	<div> <div>C</div> <div> <div>• NC</div> <div>• NO</div> </div> </div>
Point B	<div> <div>C</div> <div> <div>• NC</div> <div>• NO</div> </div> </div>

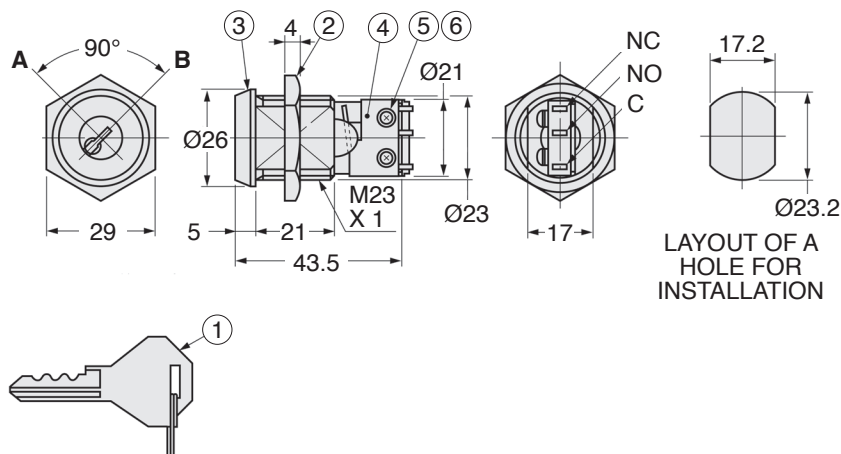



## CAM LOCK LEVERS



### • CAM LOCK LEVERS

Catalog Number	Material	Finish	Net Weight g
MNBT06MTL96K-1	Steel	Bright Zinc Plated	17.5
MNBT06MTL96K-2			19
MNBT06MTL96K-3			21
MNBT06MTL96K-4			14.5
MNBT06MTL96K-5		Zinc Plated	12
MNBT06MTL96K-6			

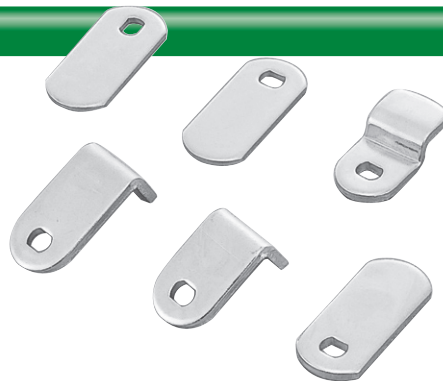

6

...MTL96K-1

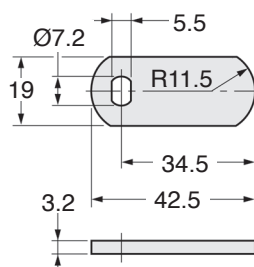

...MTL96K-2

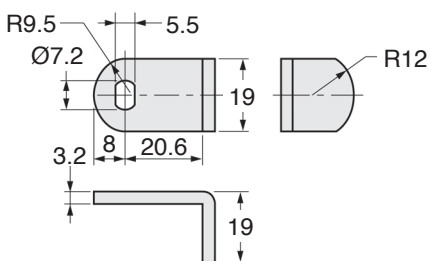

...MTL96K-3

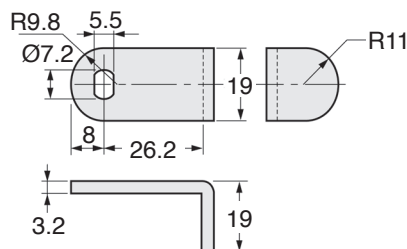

...MTL96K-4

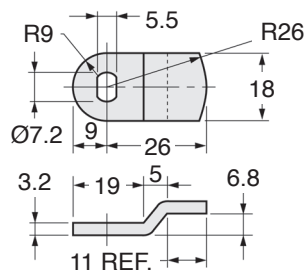

...MTL96K-5

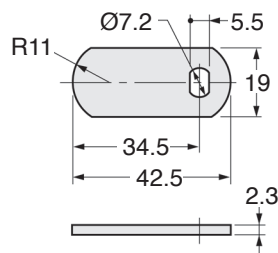

...MTL96K-6

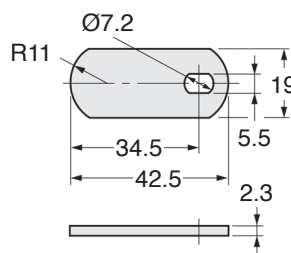

These levers can be used with: MNBT03MTL245, MNBT05MTL247, MNBT05MTL251, MNBT05MTL252, MNBT07MTL96L, MNBT07MTL96S-1